

QUICK START GUIDE



QUICK START GUIDE

086511 - SnailFence kit S6 (20m)



Content Kit

- A S6 Solar Energizer 1 pc.
- B Snailtape 20 mtr.
- C Lead-out connection cable 10 mtr.
- D Earth stake with connection wire 1 pc.
- E Mounting screws 200 pcs.
- F Snailtape connection box 1 pc.



Start here...

1



2

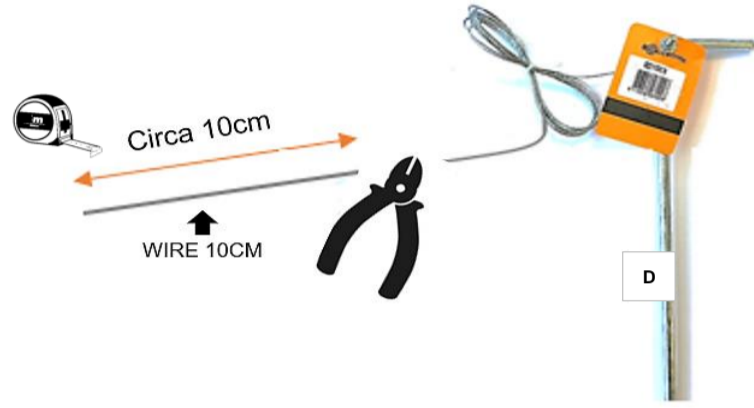

3



4

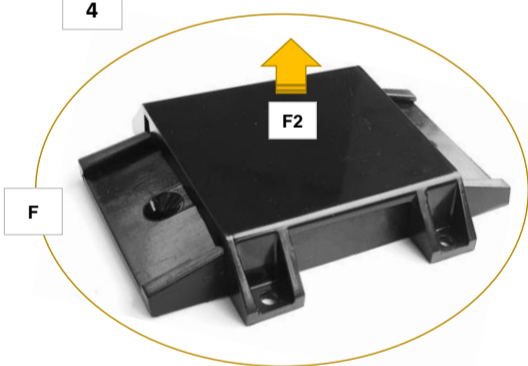

5

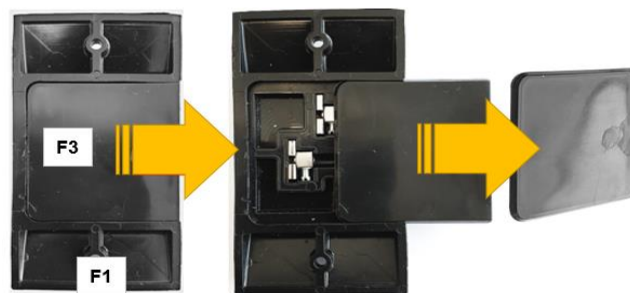

6

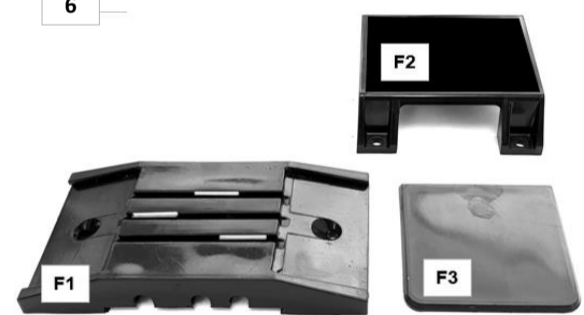

7

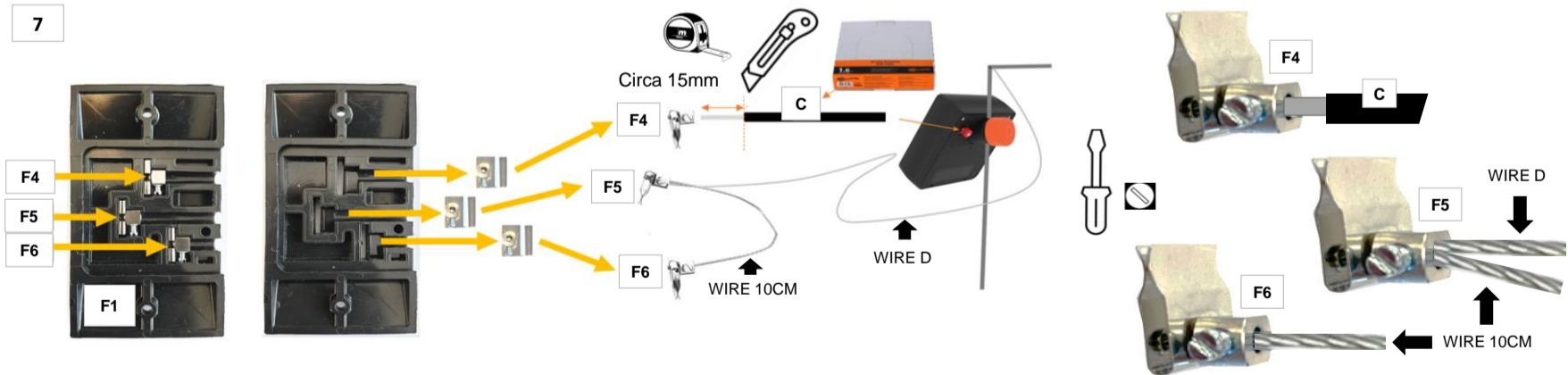

8

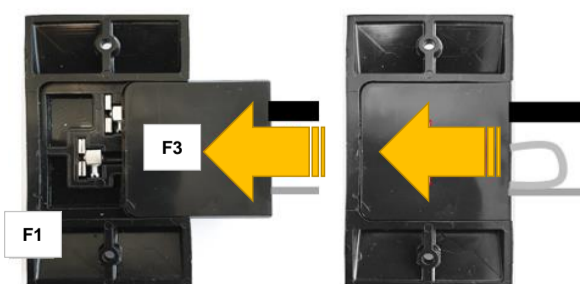

9

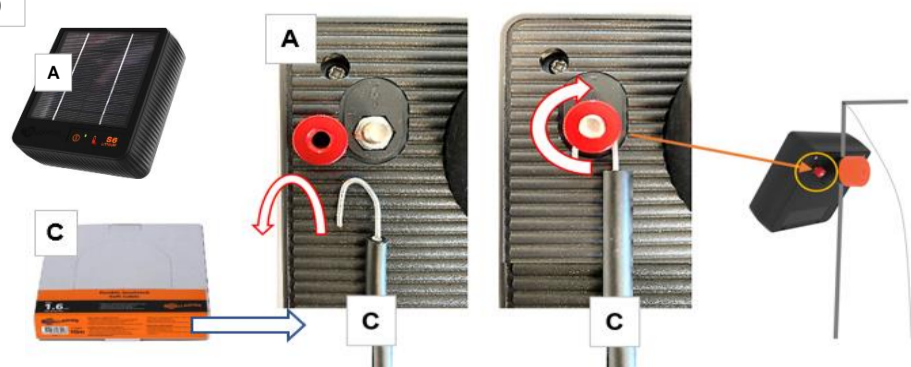

QUICK START GUIDE

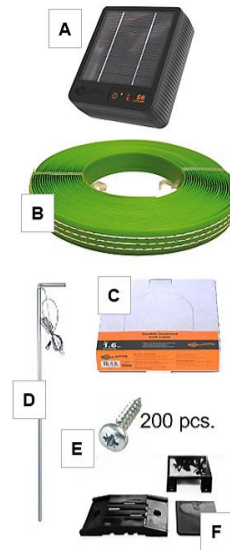

086511 - SnailFence kit S6 (20m)



Content Kit

- A S6 Solar Energizer 1 pc.
- B Snailtape 20 mtr.
- C Lead-out connection cable 10 mtr.
- D Earth stake with connection wire 1 pc.
- E Mounting screws 200 pcs.
- F Snailtape connection box 1 pc.

Continue here...

10

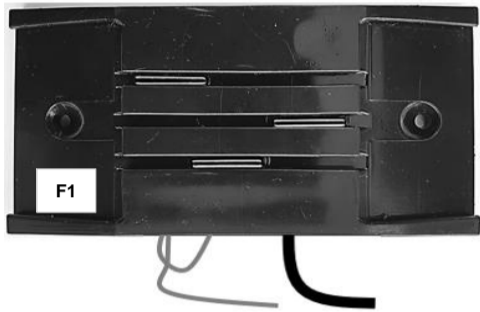

11

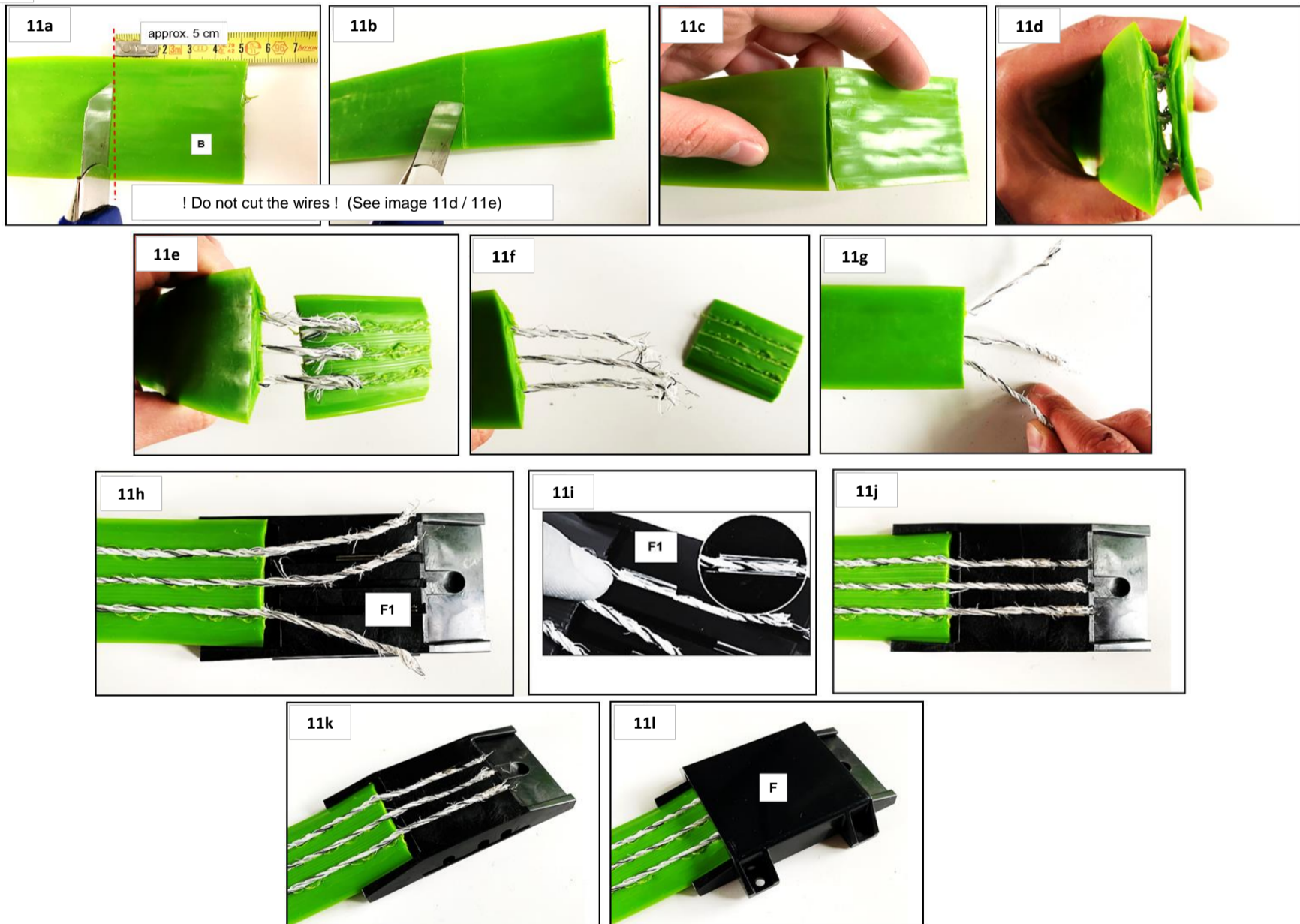

12

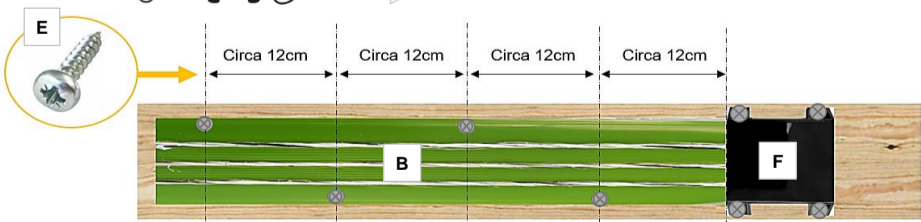

13

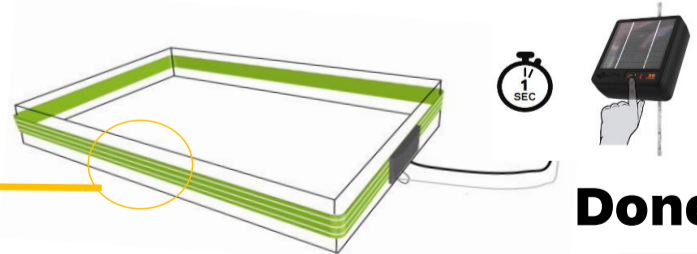

Done!



EN-Charging battery for first use. Switch the energizer off, place in sunlight for 3 days to charge battery. **NL-**Batterij opladen voor eerste gebruik. Schakel de Energizer uit. Zet gedurende 3 dagen in het zonlicht om de batterij op te laden. **FR-**Chargement de la batterie pour la première utilisation. Mettez l'électrif cateur hors tension. Placez-le au soleil pendant trois jours pour recharger la batterie. **GE-**Aufladen des Akkus für den ersten Gebrauch. Schalten Sie das Weidezaungerät aus. Legen Sie das Gerät zum Aufladen des Akkus 3 Tage in das Sonnenlicht. **SV-**Ladda batteri för första användning. Stäng av laddningsaggregatet. Placera aggregatet i solljus under tre dagar för att ladda upp batteriet. **DK-**Oplader batteri til første brug. Slå strømforsyningen fra. Anbring den i sollys i tre dage for at oplade batteriet. **IT-**Ricarica della batteria per il primo utilizzo, Apague el energizador. Expóngalo a la luz solar durante 3 días para recargar la batería.

